



GRWE95 Series Water and Power Pedestal

User manual

ZheJiang Geeya Intelligent Technology Co., Ltd

February 2025



The device casing must be reliably grounded.



Ensure all wiring is correctly connected before turning on the power. If any abnormality occurs after powering on, immediately disconnect the power and check the wiring.



After completing the wiring, be sure to close the inspection door or seal the inspection port.

Table of Contant

GRWE95 Series Water and Power Pedestal.....	1
1 Overview.....	1
1.1 Application Scope.....	1
1.2 Product Features.....	1
1.3 Functional Configuration.....	1
1.4 Functional Configuration.....	3
1.4.1 Main Parameters.....	3
1.4.2 Mechanical Performance.....	3
1.4.3 Environmental Conditions.....	3
2 Installation.....	4
2.1.1 Installation Dimensions.....	4
2.2 Wiring Method and Bracket Installation Process.....	4
3 Unpacking and Debugging.....	7
3.1 Unpacking Inspection.....	7
3.2 Debugging and Maintenance.....	7
4 Ordering and Selection.....	8
4.1 Model Description.....	8
4.2 Ordering information.....	8
5 Technical Support.....	9

1 Overview

1.1 Application Scope

The GRWE95 series water and power pedestals use 304 stainless steel, offering excellent waterproof, corrosion-resistant, and UV-resistant capabilities. They are designed for prolonged outdoor use in humid, high-exposure environments.

1.2 Product Features

Waterproof, dustproof, and electric shock-proof sockets ensure safer and more reliable power usage.

Made of 304 stainless steel with integrated sealing technology for excellent waterproof, moisture-proof, and UV-resistant performance.

The faucet adopts an outdoor brass ball-core design, providing outstanding frost resistance.

1.3 Functional Configuration

The appearance of the GRWE95 series water and power pedestal is shown in Figure 1.

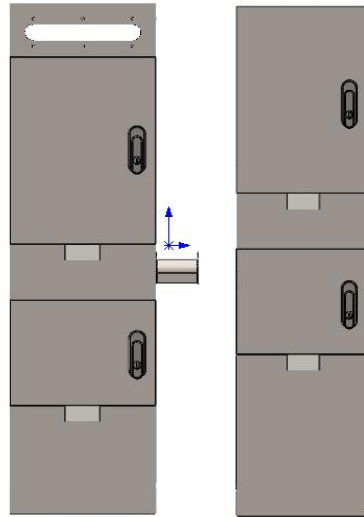

Figure 1: Appearance Diagram of the GRWE95 Series Water and Power Pedestal

Table 1: Functional Configuration Table of GRWE95 Series Water and Power Pedestal:

Table 1 GRWE95 Series Water and Power Pedestal function configuration table

Model	GRWE952520S	GRWE952520S-R
Color	Original color	Original color
Material	304 stainless steel	304 stainless steel
Input Power	AC125V/250V 50A	AC125V/250V 50A
Waterproof socket	4	4
Faucet	2	2
Light	None	3W LED
Leakage protector	1	1

Note: The optional items listed in the table can be selected according to specific requirements when ordering.

1.4 Functional Configuration

1.4.1 Main Parameters

Power Supply: Rated voltage AC250V ($\pm 20\%$), frequency 50Hz, power consumption $< 10\text{W}$.

1.4.2 Mechanical Performance

Oscillation, shock, and tilt-drop comply with GB 2099.3-2015 relevant standards.

1.4.3 Environmental Conditions

- 1 **Ambient Temperature:** -30°C to $+60^{\circ}\text{C}$.
- 2 **Power Grid Voltage Fluctuation Range:** AC250V $\pm 20\%$.
- 3 **Surrounding Environment:** No corrosive gases, no conductive dust, and no flammable or explosive media present.

2 Installation

2.1.1 Installation Dimensions

The installation dimensions of the GRWE95 series water and power pedestal are shown in **Figure 2** below.

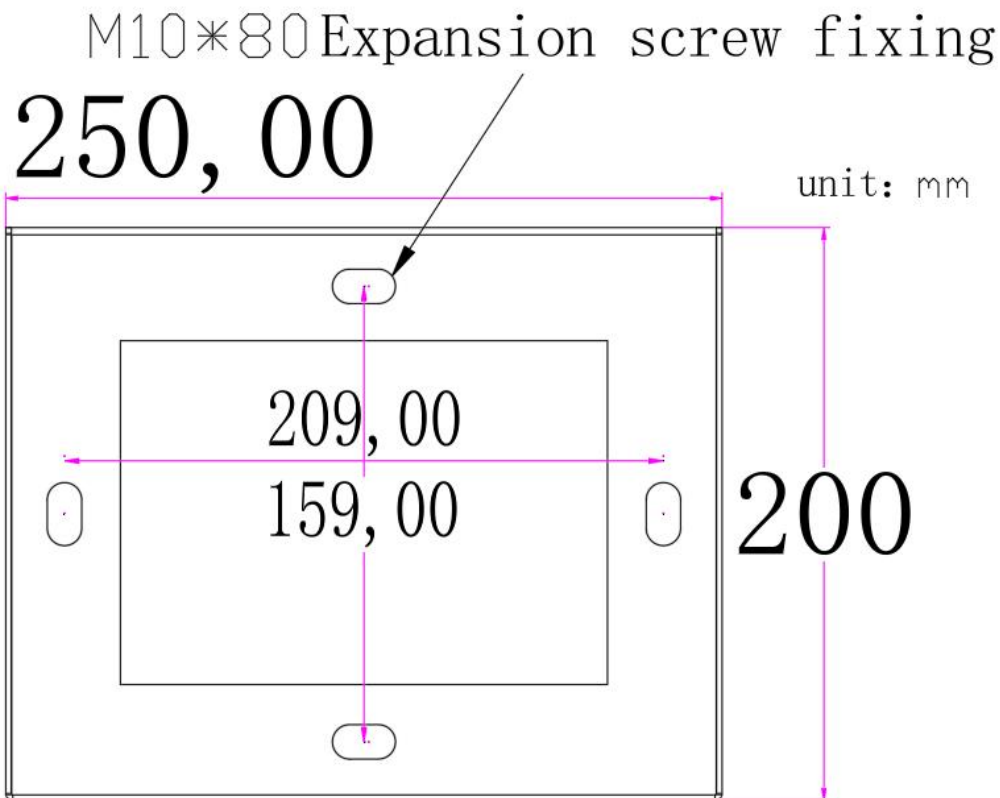

Figure 2: Installation Dimensions of the GRWE95 Series Water and Power Pedestal

(Fix with expansion bolts.)

2.2 Wiring Method and Bracket Installation Process

Note: Electrical wiring must be performed by a qualified professional.

The pedestal reserves a live wire (red), a neutral wire (blue), and a ground wire (green). Follow the terminal instructions for wiring. Waterproof connectors can be used for intermediate connections.

The hook installation process is shown in **Figure 3: Bracket Installation Process Diagram** below.

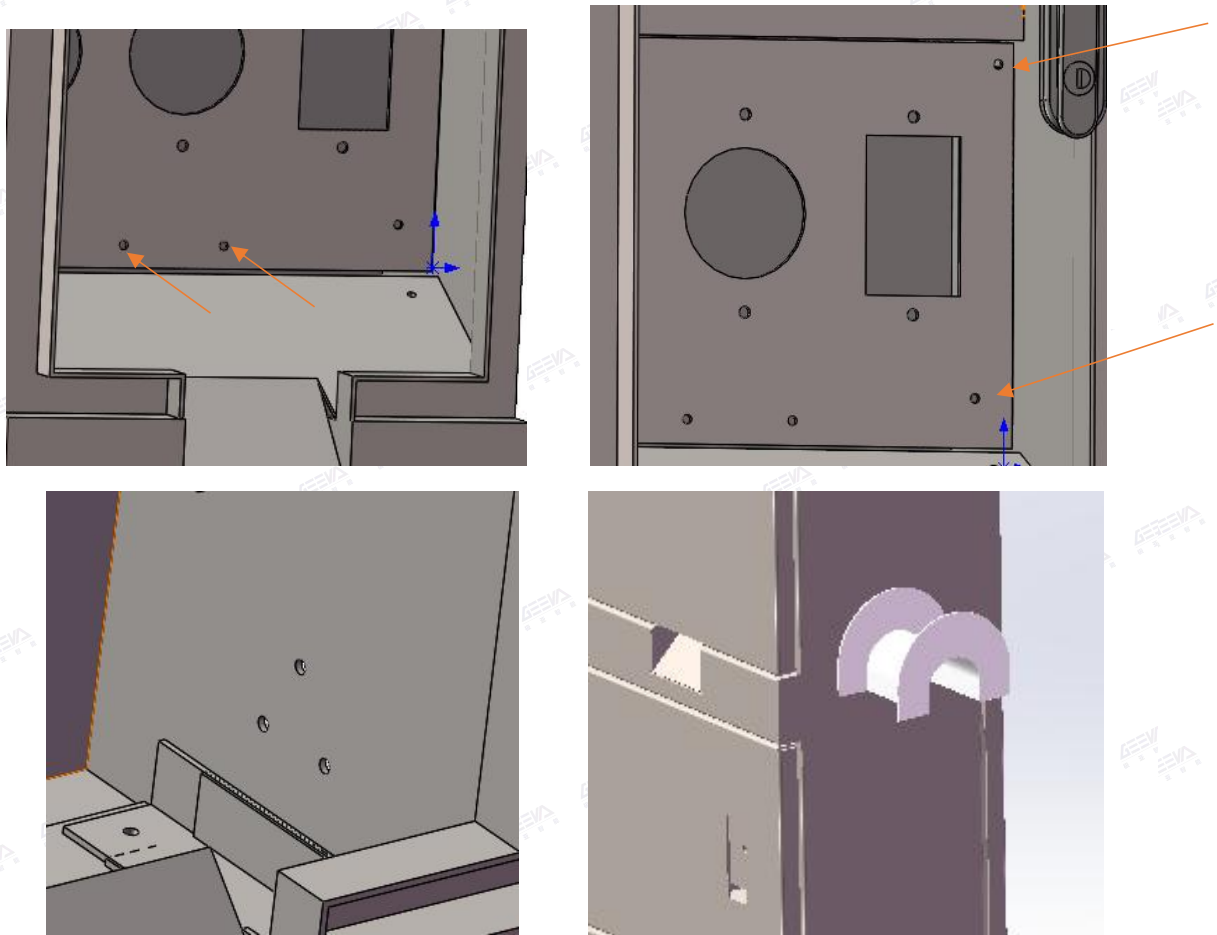
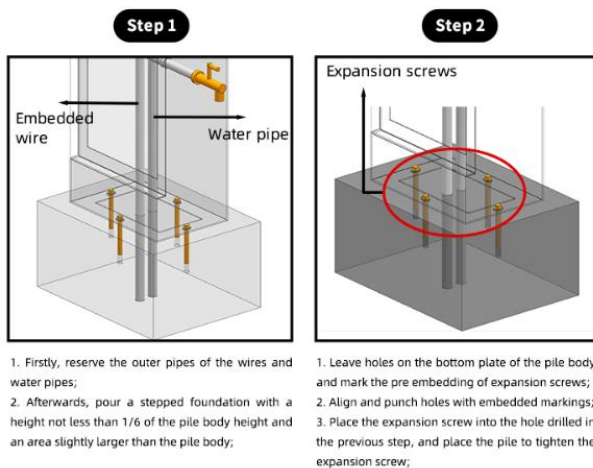

Figure 3: Hook Installation Process Diagram

First, loosen the two screws below the socket panel, but do not remove them. Then, remove the four screws on the left and right sides of the socket panel. After removing them, three holes will be visible. Align the three holes of the hook with the three holes on the pedestal body and secure them with screws and nuts. Next, adjust the socket panel and the lower cover into position, then tighten the four screws on the left and right sides of the socket panel. Finally, tighten the two screws on the lower cover, completing the hook installation.



Step 1: First, reserve conduit for electrical wires and water pipes. Then, construct a step-shaped foundation with a height of at least $1/6$ of the pedestal height and an area slightly larger than the pedestal.

Step 2: Align with the reserved holes on the pedestal base plate to mark the positions for embedding expansion bolts. Drill holes at the marked positions, insert the expansion bolts into the drilled holes, place the pedestal, and tighten the expansion bolts securely.

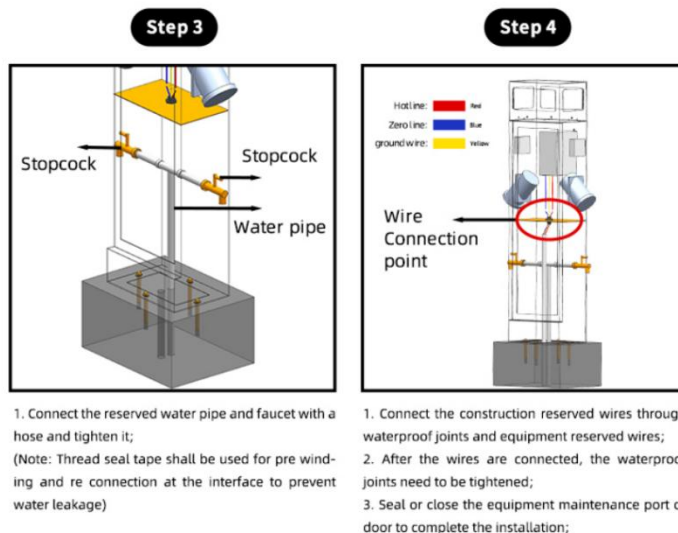

Step 3: Connect the pre-installed water pipe to the faucet using a flexible hose and tighten it.

(**Note:** Wrap the connection with sealing tape beforehand to prevent leaks.)

Step 4: Connect the construction-reserved electrical wires to the device's reserved wires, ensuring waterproof and leakage protection at the connection points. Finally, close the equipment inspection door to complete the installation.

3 Unpacking and Debugging

3.1 Unpacking Inspection

Upon receiving the product, the user should immediately perform an **unpacking inspection**:

1. Verify the product model against the **order contract** to ensure accuracy.
2. Check the **accessory list** to confirm that all documents and parts inside the package are complete.
3. Inspect the product for any **damage or contamination** that may have occurred during transportation.

1)

3.2 Debugging and Maintenance

1 When performing maintenance on the product, follow **safety regulations** and ensure the product is **disconnected from the power grid**.

2 The primary maintenance task is **dust removal**, and operators should follow these steps:

- a) Conduct a **comprehensive visual inspection** of the product.
- b) Wipe the surface of all components with a **dry cloth**.
- c) Check that **internal terminal connections** are securely fastened to prevent accidents caused by loosened parts.

3 **Safety Instructions**:

- a) Product testing, installation, and maintenance **must be carried out by qualified professionals** in accordance with **electrical equipment safety operation procedures**.
- b) Once the product is in use, **do not touch any part of the socket** while it is powered on to prevent electric shock accidents.

a) •

4 Ordering and Selection

4.1 Model Description

The **first two letters** indicate the product category (**WE** for water and power pedestals).

The **first set of numbers** represents the **pedestal height**.

The **second set of numbers** represents the **pedestal length**.

The **third set of numbers** represents the **pedestal width**.

The **fifth letter** indicates whether the pedestal is **single-sided (S)** or **double-sided (D)**.

The **last letter(s)** represent optional configurations (**R for button light, LR for light-controlled light**).

4.2 Ordering information

When placing an order, please specify:

1. **Device model, name, and order quantity.**
2. **Detailed specifications** according to the listed model and name.
3. **Special functional requirements** and any necessary spare parts or accessories.
4. **Delivery address, recipient organization, and delivery schedule.**